



31 Townhomes at Islas del Mar

Rocky Point (Puerto Peñasco), México



Location



Eagle Village is located at Islas del Mar, one of the finest gems in Rocky Point. Its amenities and services, such as the navigable lagoons, and more than 1.5 mile of beach front to the Sea of Cortez, make the place unique.

Rocky Point, a 3.5 hr. drive from Phoenix and Tucson, is considered Arizona's beach and an important tourist destination of northern Mexico.

It hosts more than 2.2 million visitors per year, mainly from the US and Canada.

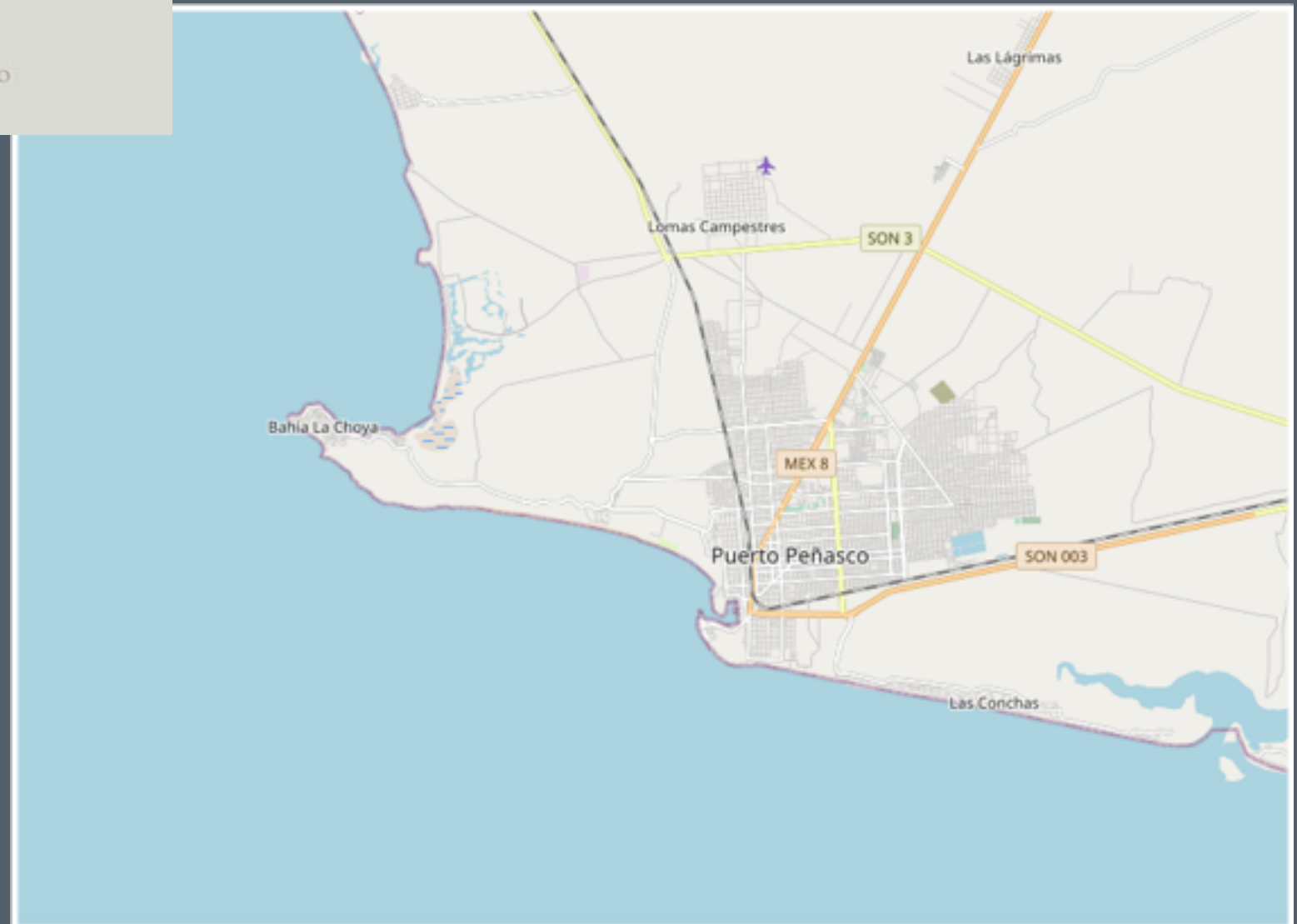



Islas del Mar

Islas del Mar is a development with a total surface of 700 acres, 1.5 mile of beach front and 170 acres of salt water navigable lagoons that are renewed daily with the tides of the Sea of Cortez.

Only 10 minutes drive from bustling downtown Rocky Point, you can enjoy peace and relaxation with your family in a unique natural environment.

Jack Nicklaus Signature Golf course with Club House and Restaurant in service.

Gated community, 24hrs security.

First class infrastructure: desalination plant, waste treatment plant, drainage system and underground facilities: fiber optic, electricity, and water.



The Project

Aerial View



Amenities

To live in one of Eagle Village's townhomes, means to enjoy the amazing views of the wildlife, the lagoon, the desert, and the sea, as well as the worldwide famous sunsets.

Eagle Village consists of a 31 unit, 1,400 Sq.Ft. townhome complex, with an extensive sea-water lagoon front, common areas and pool amenities.

Large living areas, patios, and porches, along with its relaxing lounge area, will make your friends and family gatherings unforgettable.

Idyllic landscapes along with the most peaceful and discrete environment, make Islas del mar ideal to relax and enjoy life.



Standard Unit



Project details

- ◆ 1,400 Sq. Ft.
- ◆ 2 Master Bedrooms
- ◆ 2.5 Bathrooms
- ◆ 2 Balcony/Patios
- ◆ Surface Parking
- ◆ 2 Stories
- ◆ Lounge area
- ◆ Dining and Living room
- ◆ Kitchen
- ◆ Laundry room

Location at Islas del Mar

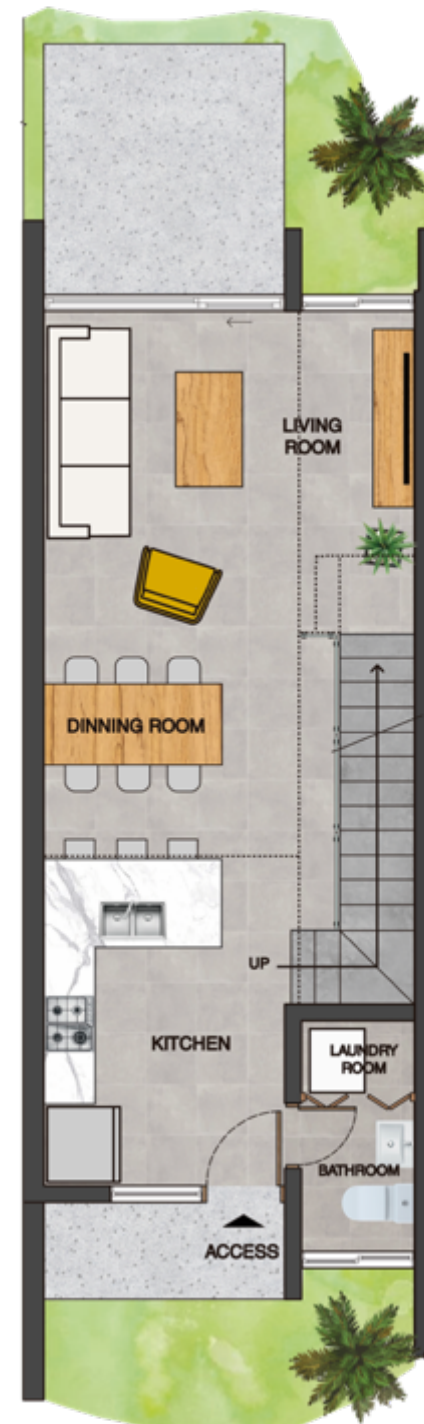

Ground Floor



Second Floor

Units on sale



Units on sale from
285,000 USD

Payment method

- ◆ 10,000 USD Initial Deposit
- ◆ 30% Down Payment
- ◆ 70% at Home delivery

Financing available

- ◆ Banco Santander
- ◆ Global Mortgage







Information

www.eaglevillage.mx

info@eaglevillage.mx

Carretera Entronque Cerro Prieto km 6.5. S/N, Centro,
83550 Puerto Peñasco, Sonora México.